

180° Peel Adhesion

For added testing flexibility, the ChemInstruments 180° peel adhesive testing machine can perform a precision 180° peel test at three different speeds. The 180° peel adhesive tester offers a number of robust features.

- Rugged construction, capable of withstanding the abuse of the production environment
- Digital speed control with encoder feedback
- Selectable speeds of 6, 12 and 24 ipm (15, 30 and 60 cpm)
- Test angle is permanently set for 180° testing
- 10 pound load cell is included with the machine
- Test samples as short as ½" to as long as 6" (12mm - 150mm)
- Designed to accept standard 2" x 6" peel panels (50mm x 150mm)
- Operating temperature range 32° - 150° F (0° - 70° C)
- Capable of stand-alone operation with integrated digital display
- Data can be downloaded to EZ-Lab software for complete data management
- Accurate to ± 0.1% of load cell range
- Capable of pulling up to 10 pounds (4.5 Kg)
- Universal input voltage from 85 - 265 VAC (50/60hz)

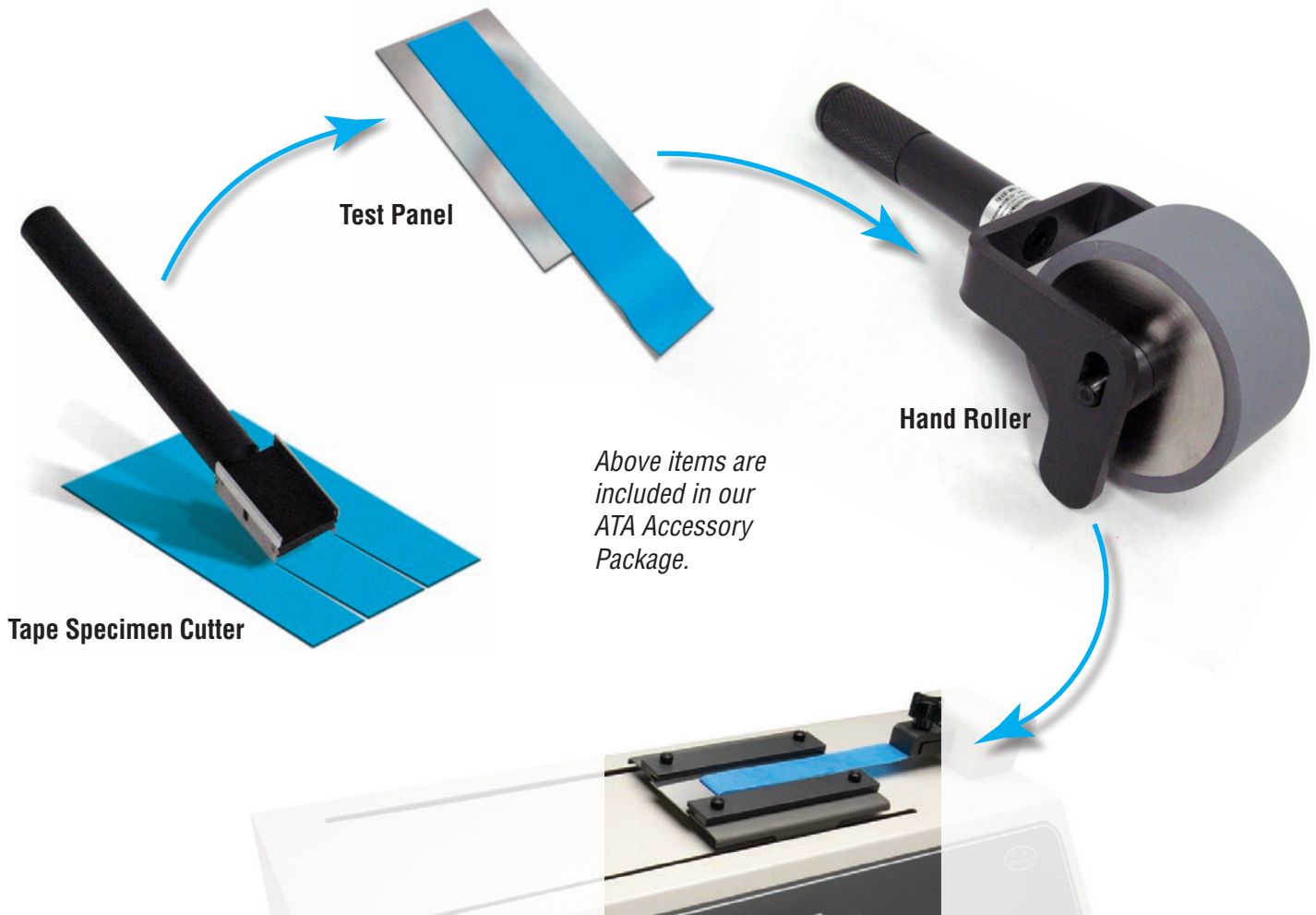



Above items are included in our ATA Accessory Package.

Data Acquisition System

The ChemInstruments electronic data acquisition system is a state-of-the-art microprocessor controlled force measurement package that combines accuracy with ease of use. This system simultaneously controls test motion, reads the force of a test from a load cell, digitally displays it and also stores that data in its memory.

- Records 400 data points per second during a test interval
- Displays the average, high and low measured force results immediately upon completion of a test
- Export data by RS-232 connection to a local PC with our EZ-Lab software
- Displays test values in grams, kilograms, ounces, pounds or Newtons

Tape Specimen Cutter: A double razor blade sample cutter cuts samples to a precise 1 inch width. Other sizes available.

Test Panel: Standard size for all ChemInstruments Shear Testers. Test Panels manufactured to PSTC specifications.

Hand Roller: Used to laminate samples to test panels.



PSTC Testing Kit
TLMI Testing Manual